



Montsalvat
**EXHIBITOR
INFORMATION
2024**

EXHIBITION GUIDE & FAQs

Montsalvat is an arts centre and creative community founded in the 1930's located on Wurundjeri-willam country - Eltham, Victoria, Australia. The ethos of Montsalvat is to foster a thriving, creative artistic community. We welcome local, national and international cultural and artistic practices that diversify and expand the current arts landscape.

Exhibitors pay a **non-exclusive** hire fee to display their artwork in the gallery. Alongside exhibitions, Montsalvat hosts a range of exciting programs including creative events, functions, workshops, meetings and more inside our gallery spaces. This presents an opportunity for the exhibiting artists' work to be viewed by many Montsalvat visitors providing additional exposure during and outside of open visitation hours. Please note - this may impact public access to the exhibition during open hours. Please call ahead to enquire if the gallery is accessible to plan your visit.

Exhibitors will be required to meet with the Creative Program Coordinator at Montsalvat to confirm the exhibition agreement and tour the selected gallery space of their exhibition. Montsalvat's buildings are unique Heritage-listed spaces with natural climate control.

Montsalvat respectfully acknowledges the Wurundjeri Woi-wurrung people of the Kulin nation as the Traditional Owners of the Country on which Montsalvat is built and operates.

Montsalvat respectfully acknowledges the founding families of Montsalvat, the Jörgensen and Skipper families.

Image cover page: Lesley Sinclair, Montsalvat Forge (detail), c.1970s, oil paint on canvas ©

Hire fees are reviewed annually in line with CPI and sustainable business practice

THE BARN GALLERY

ABOUT

The Barn Gallery is a multi-use, heritage-listed creative venue regularly used at Montsalvat as an exhibition and concert venue.

Formally known as the “The Red Brick Barn” or “The Boat Shed”, the original building was designed by Montsalvat founder Justus Jørgensen and constructed in three stages in 1957. Due to a fire that caused significant damage, the building was primarily rebuilt during the 1990s by Hamish Knox. The Barn Gallery now comprises a large space with polished concrete floors, rendered mud-brick walls, elevated windows, natural timbers, chandelier elements crafted by Matcham Sipper and a Yamaha grand piano.

FACILITIES

- Track Lighting Gallery Standard
- Track hanging system
- Double door access for accessible installation
- Rendered mudbrick walls
- A **multi-use** space hosting public events
- Ceiling fans
- Sound system and microphone on stage

ACCESSIBILITY

The Barn Gallery is wheelchair accessible through the front doorway entrance and hosts large rear doors. Accessible toilets are available in the courtyard.



Image: courtesy of Montsalvat

THE BARN GALLERY



Image: courtesy of Montsalvat

HIRE RATES - Non Exclusive hire

\$500 per week excluding GST

Art sales commission: 33.33% GST exclusive

DURATION: Minimum of 4 weeks

(this can be extended through confirmation with the Creative Program Coordinator)

INCLUSIONS FOR THE EXHIBITOR

- 1 set of Title blocks/labels
- Provision of track and gallery hanging system
- Provision of ladders
- Plinths are available for loan/hire
- Provision of partition walls as required for hire
- Sales administration
- Use of AV equipment: microphone and soundsystem
- Marketing copy through online social media channels, Instagram and Facebook, with 11,000+ subscribers
- Printing of artwork room list (worklist & catalogue to be organised by exhibitor following proofing from Creative Program Coordinator)
- Promotional copy through ArtsHub and other channels
- 1 slot in the Montsalvat E-newsletter promotion of 5,500+ and printed seasonal program.
- Digital billboard advertising at the visitor services desks
- All arrangements coordinated for opening and catering (cost to be paid by the artist)

THE BARN GALLERY

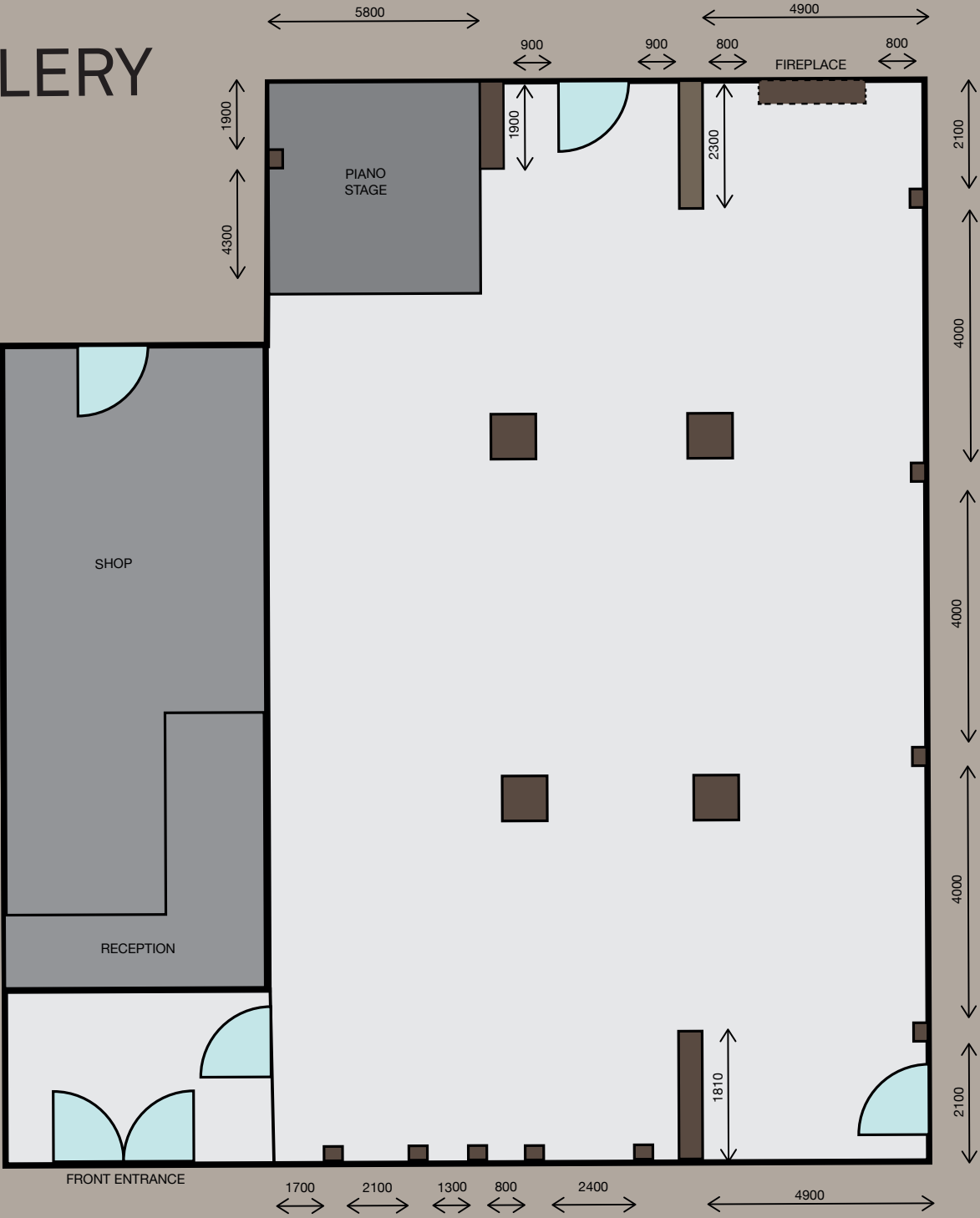

THE RESIDENTS GALLERY



Image: Photograph by Hilary Walker -
commissioned by Public Journal

ABOUT

The Residents Gallery, also known as Betty Roland's House, aka Helen's Residence - built c.1971
Originally a chook house, then a school for the Colony's children, the space became a dwelling for Betty Roland and then Helen Skipper.
Designed by Justus Jorgensen, funded and built for Betty Roland, author of *The Eye of the Beholder*, the Resident's Gallery is now an exhibition space hosting works past and present.

FACILITIES

- Track Lighting Gallery Standard
- Track hanging system
- Double door access one through to the cafe and one door to the courtyard
- Beverage Station (for openings)
- Located in the Barn Gallery courtyard
- Courtyard surrounded by Matcham Skipper sculptures

ACCESSIBILITY

The Residents Gallery is situated outside the Barn Gallery in the courtyard and is accessible through the restaurant, with convenient access to toilets.

THE RESIDENT'S GALLERY



Image: courtesy of Montsalvat

HIRE RATES

\$180 per week excluding GST

Art sales commission: 33.33% GST exclusive

DURATION: Minimum of 4 weeks (this can be extended through confirmation with the Creative Program Coordinator)

INCLUSIONS FOR THE EXHIBITOR

- 1 set of Title blocks/labels
- Provision of track wire and hook hanging system
- Provision of ladders
- Provision of available plinths for loan/hire
- Sales administration
- Use of AV equipment: microphone
- Marketing copy through online social media channels, Instagram and Facebook, with 11,000+ subscribers
- Promotional copy through ArtsHub and other channels
- Printing of artwork room list (catalogue to be organised by exhibitor following proofing from Exhibition Coordinator)
- E-newsletter promotion of 5,500+ and printed seasonal program
- All arrangements for opening and catering coordinated (catering cost to be paid by the artist)

THE RESIDENT'S GALLERY

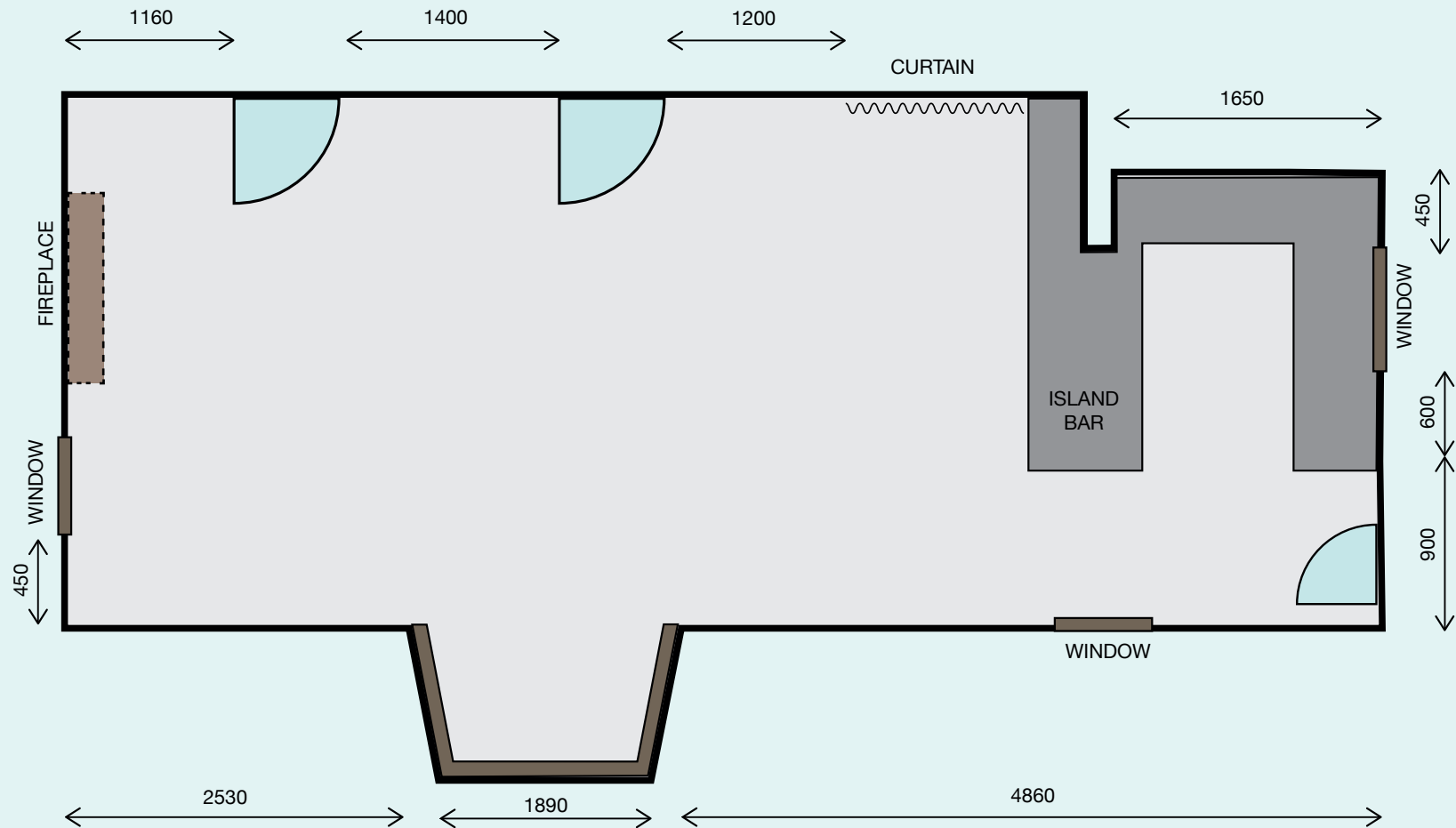

*Dimensions indicate available wallspace

THE LONG GALLERY



Image: courtesy of Montsalvat

ABOUT

The Long Gallery is an exhibition and multi-use space by The Ornamental Pond (pool). Designed by Justus Jorgensen, the walls were built approx. c1945, predominantly by Horrie Judd, renowned for his stone and building skills. The salvaged trusses, roof, polished ceramic tile floor, windows and doors make a distinctive Heritage-listed space. This creates a unique experience for exhibitors.

FACILITIES

- Kawaii upright piano
- Poolside with door access
- Fireplaces (can be lit in colder months)
- Track Lighting Gallery Standard
- Track hanging system
- Front and Rear access for accessible installation
- Beverage Station (for openings)
- A **multi-use** space for events and programs increasing public traffic

ACCESSIBILITY

The Long Gallery has two entrance points at the front and the back of the building. Parking is available at the Long Gallery for wheelchair access, and installation days.

THE LONG GALLERY



Image: courtesy of Field of Vision Photography

HIRE RATES

\$320 per week excluding GST

Art sales commission: 33.33% GST exclusive

DURATION: Minimum of 4 weeks (this can be extended through confirmation with the Creative Program Coordinator)

INCLUSIONS FOR THE EXHIBITOR

- 1 set of Title blocks/labels
- Provision of track wire and hook hanging system
- Provision of ladders
- Provision of available plinths for loan/hire
- Sales administration
- Use of AV equipment: microphone and soundsystem
- Marketing copy through online social media channels, Instagram and Facebook, with 11,000+ subscribers
- Printing of artwork room list (catalogue to be organised by exhibitor following proofing from Exhibition Coordinator)
- Promotional copy through ArtsHub and other channels
- E-newsletter promotion of 5,500+ and printed seasonal program
- All arrangements for opening and catering coordinated (catering cost to be paid by the artist)

THE LONG GALLERY



Image: courtesy of Nikola Janev Photography

CAPACITY: 130 STANDING

THE LONG GALLERY

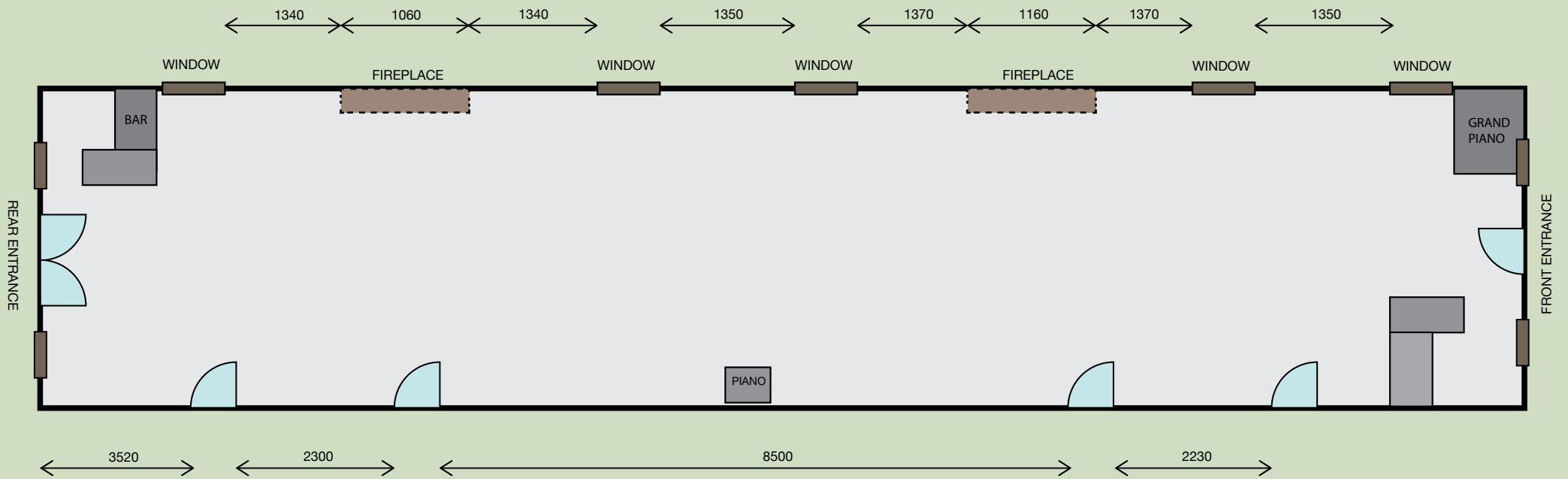

*Dimensions indicate available wallspace

SKIPPER STUDIO

ABOUT

The Skipper's Studio has undergone a multifaceted evolution since its inception, transforming from a garage and store to a cool room, and eventually, since the 1950s, into a dynamic studio and workshop. It has played an integral role in the vibrant household of the esteemed Skipper family, including the artists Matcham and Myra (Gould) Skipper, along with their gifted children. Over the years, this enchanting corner of Montsalvat has not only been a residence but also a space where the family has lived, built, worked, and created art.

FACILITIES

- Track Lighting Gallery Standard
- Track hanging system
- Antique cabinetry suited for jewellery and 3D work displays
- Matcham Skipper made table heritage listed
- Small display window for installation.
- TV screen for video work

ACCESSIBILITY

The Skipper's Studio is located in the Skippers Complex under the Painting School on the left side of property with car access through the white gate for installation. Wheelchair accessible with a short walk from the entrance on a flat gravel pathway.



Image: courtesy of Montsalvat

SKIPPER STUDIO



Image: courtesy of Montsalvat

HIRE RATES

\$175 per week

Art sales commission: 33.33% GST exclusive

DURATION: Minimum of 4 weeks (this can be extended through confirmation with the Creative Program Coordinator)

INCLUSIONS FOR THE EXHIBITOR

- 1 set of Title blocks/labels
- Provision of track wire and hook hanging system
- Provision of step - ladders
- Provision of available plinths for loan
- Sales administration
- Use of AV equipment: TV in the space
- Marketing copy through online social media channels, Instagram and Facebook, with 11,000+ subscribers
- Promotional copy through ArtsHub and other channels
- Printing of artwork room list (catalogue to be organised by exhibitor following proofing from Creative Program Coordinator)
- E-newsletter promotion of 5,500+ and printed seasonal program
- All arrangements for opening and catering coordinated (catering cost to be paid by the artist)

MONTSALVAT EXHIBITION PROGRAM 2024



FAQs

What does non-exclusive hire mean?

Non-exclusive' means that our gallery spaces are used for various events like theatre, conferences, concerts, yoga, and markets, not just for showcasing your art. This is great because it exposes your work to different audiences. However, keep in mind that at times, the space may not be open to the public visitation during other events.

This is resolved by a quick phone call to plan your visit on the day.

Will I get help with installation?

It's the exhibitors' responsibility to install their own work. We do recommend arranging a professional, friends, and/or peers to assist you. Otherwise, we can recommend a technician to assist at an extra cost.

With your initial meeting with the Creative Program Coordinator, any questions or queries regarding logistics can be resolved on the day.

What are the hours for installation and deinstallation?

Exhibition setup takes place on Tuesdays from 9:30 AM to 5:00 PM, with the option for additional hours on Monday afternoon if needed, this can be arranged with the Creative Program Coordinator.

The exhibition should be ready for general public visitation on Wednesday.

The deinstallation occurs on Mondays from 9:30 AM to 12:30 PM.

Does Montsalvat take commission and liaise with buyers?

Montsalvat applies a 33.33% commission exclusive of GST. We facilitate the process of art sales, including administration with buyers and handling money. Following the exhibition, payment and artwork collection with the buyer is coordinated by Montsalvat.

MONTSALVAT EXHIBITION PROGRAM 2024



FAQs

Can I have an opening event?

Absolutely! We encourage you to celebrate your accomplishments. It's also a fantastic opportunity for potential art sales if that's your goal.

If an opening celebration isn't feasible, you can explore other options like hosting an artist talk or workshop. Just confirm these activities with the Creative Program Coordinator.

Opening celebrations are on a Thursday evening: 6:00pm – 8:00pm.

Can I extend my exhibition?

The minimum exhibition duration is 4 weeks. This can be extended, just reach out to the Creative Program Coordinator.

Does Montsalvat promote my exhibition?

Yes, Montsalvat promotes your exhibition, please refer to the guide for the exhibitor inclusions.

Montsalvat encourages exhibitors to take an active role in promoting their exhibitions. While we provide a platform and support for showcasing your work, the responsibility for marketing the exhibition also lies with the exhibitor. We recommend leveraging your network, utilising social media, and employing various promotional strategies to maximise the visibility and success of your showcase at Montsalvat.

When is Montsalvat open to the public?

We are open to the public Wednesday – Sunday – 10am – 4pm.

MONTSALVAT
EXHIBITION
PROGRAM 2024



FAQs

Will my exhibition be invigilated?

Montsalvat has staff on-site every day, and our reception is monitored by Visitor Services staff during opening hours. While we have dedicated volunteers, they may not always be available for invigilation in the gallery space resulting in it being unattended.

We encourage artists to spend time at the space, interact with the public, and enhance the experience for both you and the viewers.

Will I need to be GST registered?

For non-GST registered exhibitors who are engaging in a commission sale with Montsalvat the venue is required to deduct the GST liabilities at the point of payment.